



Redmayne Arnold & Harris  
estate agents, letting agents & surveyors

rah.co.uk



TO LET



20 Maris Green, Great Shelford, Cambridge, CB22 5EE

£1,300



**THE PROPERTY**

Nestled in the charming area of Great Shelford, this delightful terraced house offers a perfect blend of comfort and convenience. The inviting reception room provides a warm and welcoming space for relaxation. As you go upstairs, you will find the bathroom, ensuring that your daily routines are both comfortable and efficient. The property also features a rear garden, which presents an excellent opportunity for outdoor enjoyment.

There are two parking spaces available, a valuable asset in this desirable location. Furthermore, the property is conveniently situated near public transport links, making commuting and exploring the surrounding areas effortless. The property comes unfurnished and will be managed by RAH.

- EPC Rating: D
- Council Tax Band: D
- Minimum 12 Month Tenancy
- Deposit: £1670
- Holding Deposit: £330

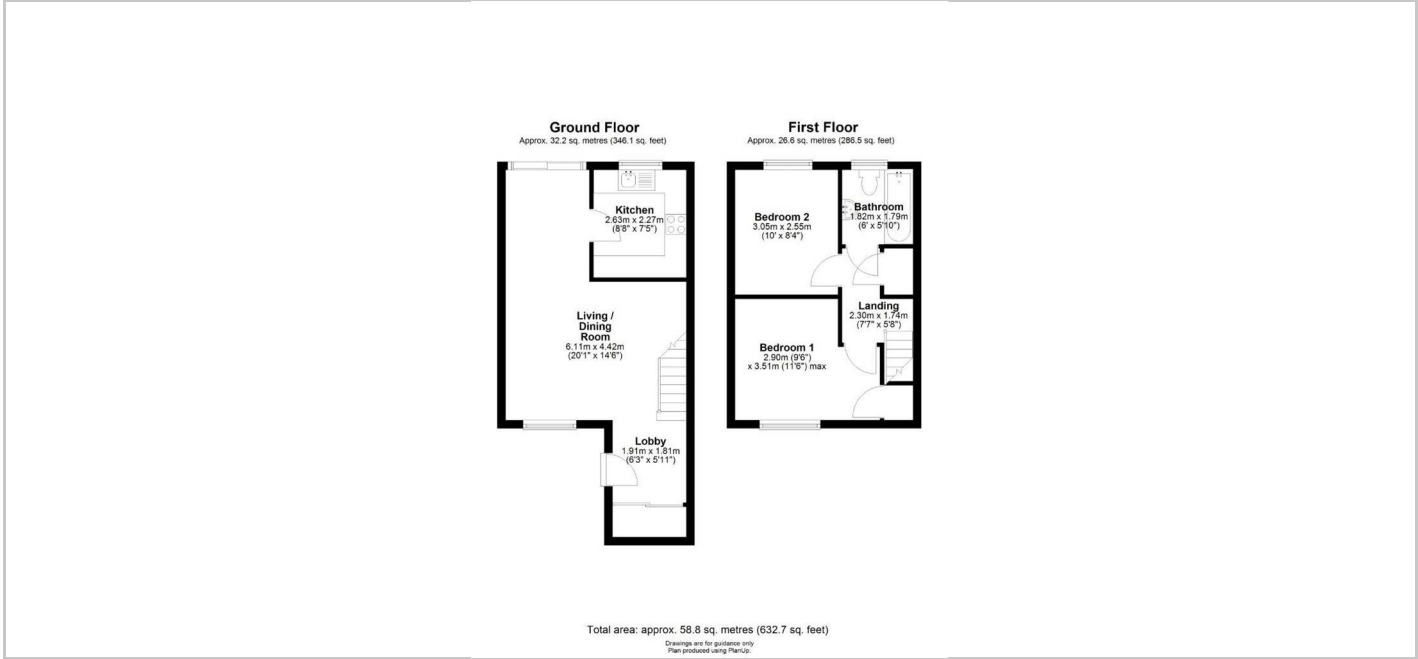

**SITUATION**

**Directions**

